

**Management Plan for
the Churchyards of
All Saints' Church,
East Budleigh**

Management Plan for the Churchyards of All Saints' Church, East Budleigh

The structure of this Management Plan is:

1. Introduction
2. 2023 Work Plan for the Churchyards
3. Three-Year Work Plan

Appendix A - Development of the Churchyards

Appendix B - Those Involved in Maintaining the Churchyards

Appendix C - Maintenance of the Memorials

Appendix D - Nature in Our Churchyards

Appendix E - Species Recorded since 2020

Appendix F - Management of Grass Cutting

1. Introduction

The All Saints' Church, East Budleigh, and churchyards fall within the East Devon Area of Outstanding Natural Beauty and the East Budleigh Conservation Area. There are two churchyards at All Saints Church, East Budleigh: a new cemetery comprising a burial ground and a garden of remembrance consecrated in July 1997; and our old churchyard.

The old churchyard was converted to a "Living Churchyard" in the 1995, following discussion with and guidance from the Diocese of Exeter, the Living Churchyard Project through the Church & Conservation Project – National Agricultural Centre and others, to enhance wildlife and its habitats.

Our aim is to have churchyards that:

- are well-managed to provide a peaceful haven for both people and wildlife
- strike a balance between being an area of peace and contemplation whilst allowing nature to flourish
- actively encourage and help sustain wildlife
- are attractive and welcoming

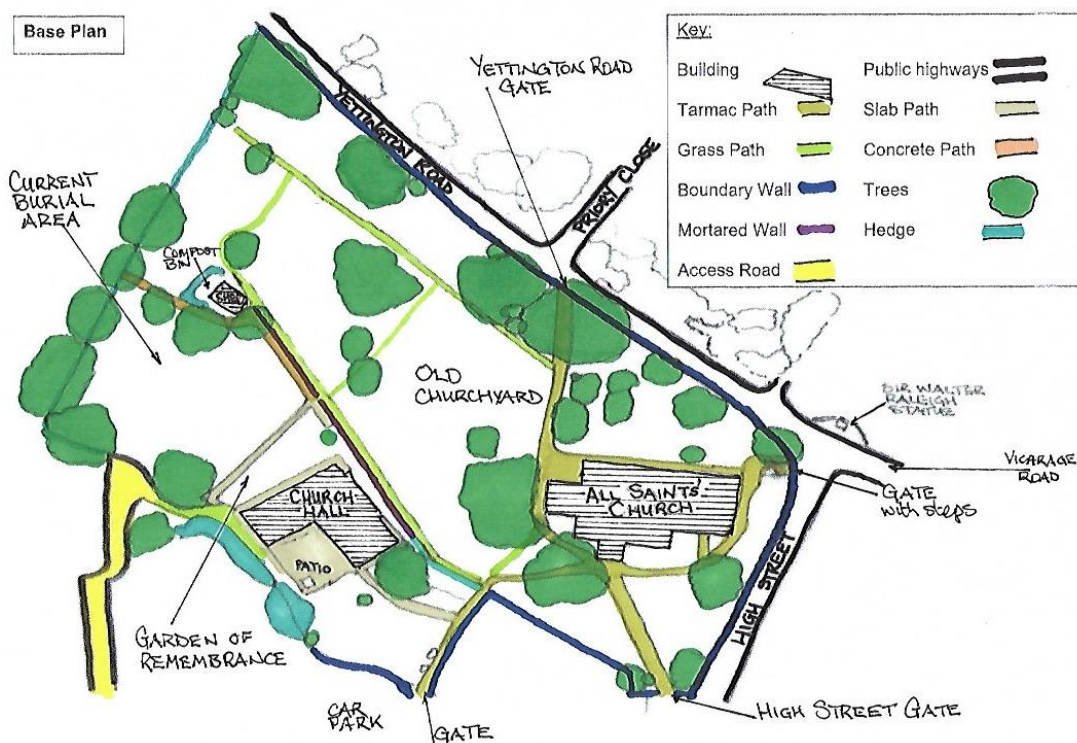

2. 2023 Work Plan for the Churchyards

Management Notes:

Walls: check if repair work is needed on the wall between old and new Churchyards and remove new ivy growth. Check the walls alongside the High Street and Yettington Road.

Hedges: trim as required but not when birds are nesting

Annual Safety inspection and check of memorials - quotation received from Orchards Memorials for work in 2023 - approved by the PCC.

Woodpile under Monterey Pine: top up as required, eg, branches, yew arisings.

Yews: remove ivy

Benches, handrails and noticeboards: check and repair/maintain as required

Bin area behind Shed: keep clear and tidy, once a month empty the recycling and rubbish bins in the appropriate manner.

Step edges and other hazards on path: highlight with paint.

Monthly check of wildlife 'facilities' for insects and hedgehogs, bird boxes and bird feeders

Signage in Churchyards: update every three months; paint woodwork as required

Documentation in the Church: update and improve information about the Churchyard

2023 Annual Work Plan														
WHAT	ACTION	J	F	M	A	M	J	J	A	S	O	N	D	
Church Hall Border	Tidy and maintain	[Yellow bar]												
Grass cuttings	Compost / Recycle Centre			[Green bar]										
Walls	Repair work needed?													
Walls	Remove new ivy growth													
Bin area	Tidy and maintain	[Brown bar]												
Compost Bin	Use well-rotted compost:													
Woodpile	Top up as required	[Orange bar]												
Yews	Remove ivy													
Trees/shrubs	Prune shrubs and hedges													
Tree Inspection	Volunteers check trees													
Benches & handrails	Repair / maintain if required													
Noticeboards	Repair / maintain as required													
Churchyard Notices	Refresh every 3 months													
Memorials	CYWP safety inspection													
	Orchards Safety Inspection													
Church Hall	Cut grass													

2023 Annual Work Plan

WHAT	ACTION	J	F	M	A	M	J	J	A	S	O	N	D
Section A	Cut grass												
Section B	Cut grass												
Section C	Cut grass												
Section D	Cut grass												
Section E	Cut grass												
Section F	Cut grass												
Section G	Cut grass												
Section H	Cut grass												
Section J	Cut grass						1/2						
Section K1	Cut grass												
Section K2	Cut grass												
Section K3	Cut grass												
New Churchyard	Cut grass												
G Remembrance	Cut grass												

Old Churchyard: in 2020, we re-defined the cutting regime with Andy Heath based on three areas in Section "K": K1, K2 and K3. In 2023, we will leave part of Section J, between the two yew trees, until September/October rather than a mid-year cut to encourage and maintain the biodiversity of species.

The Old Churchyard Sections and area around the Church Hall are cut by Andy Heath.

The New Churchyard is cut by Alan Pring, gravedigger.

The Garden of Remembrance is cut and tidied once a month by one of our volunteers.

Continue processing of grass cuttings by composting and/or taking to the Recycle Centre.

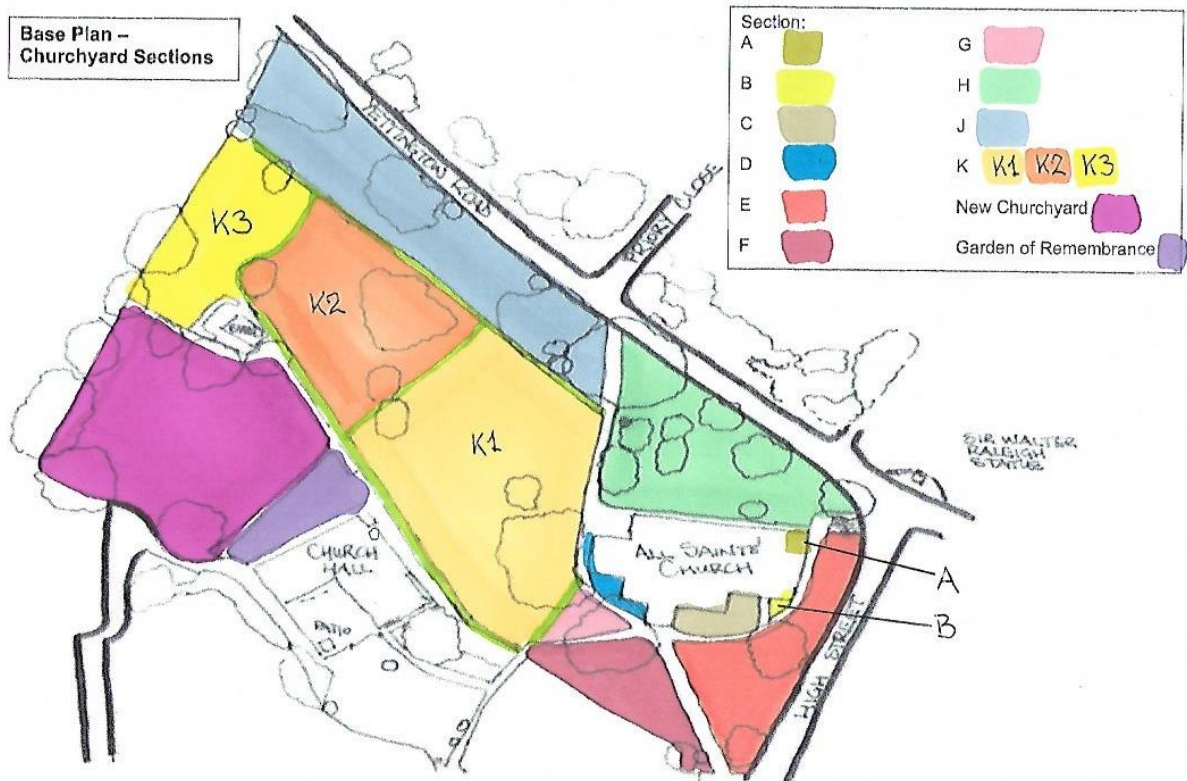

4. Three Year Work Plan

ACTIVITY	2022	2023	2024
Finalise Bin Area	█		
Remove ivy from yews and memorials	█		
Professional Tree Survey – every two years	(if required) █		(if required) █
Update Signage every 1/4	█		
CYWP Annual Safety Review of memorials	█		
Churchyard plan recording the plots/memorials	█		
Publish the memorials’ inscriptions	█		

ACTIVITY	2023	2024	2025
Remove ivy from yews and memorials	█		
Professional Tree Survey – approx. every two years	█		(if required) █
Update Signage every 1/4	█		
CYWP memorials’ Safety Review	█		
Monument fixings - Orchard Memorials	█		
Churchyard walls - remove vegetation	█		
Churchyard walls - monitor distortion	█		
Churchyard trip hazards - paint	█		
North gates - repaint	█		
Handrails - repair and repaint	█		
AG International Ltd: Churchyard plan & memorials	█		

Appendix A - Development of the Churchyards

The All Saints' Church, East Budleigh, and churchyards are within the East Devon Area of Outstanding Natural Beauty and the East Budleigh Conservation Area.

There are two churchyards at All Saints Church, East Budleigh: a new cemetery comprising a burial ground and a garden of remembrance consecrated in July 1997; and the old churchyard.

The old churchyard was converted to a "Living Churchyard" in the mid-late 1990s, following discussion with and guidance from the Diocese of Exeter, and the Living Churchyard Project through the Church & Conservation Project – National Agricultural Centre, to enhance wildlife and its habitats. Stuart and Janet Lovett were responsible for the management overview and the Churchyard Working Party until 2017.

The old churchyard was divided into a number of Sections in 2004 when the records of the memorials were developed. We use the Section references within this document.

Our aim is to have churchyards that:

- are well-managed to provide a peaceful haven for both people and wildlife
- strike a balance between being an area of peace and contemplation whilst allowing nature to flourish
- actively encourage and help sustain wildlife
- are attractive and welcoming

Appendix B - Those Involved in Maintaining the Churchyards

We do not have a full-time, paid person responsible for the churchyard as, like most churches, we do not have vast sums of money. The gravedigger, Alan Pring, cuts the new churchyard grass, the cost is covered by the PCC (Parochial Church Council). We employ a local gardener, Andy Heath, to regularly cut the grass in the old Churchyard, the grass paths in the old Churchyard, and around the Church and Church Hall - the cost is covered by the PCC.

The remainder of the work is done by the Churchyard Working Party. They maintain the new churchyard and memorial garden, eg, cutting around the memorials in the grass. They also keep the surroundings of the Church and Church Hall in good order, including the footpaths, handrails, grass paths, plants, hedges, shrubs and trees.

Our Churchyard Working Party usually meets on the third Friday of the month – these are all volunteers. We start at 10.00, have a coffee break at 11.00 and carry on until 12.00 – 13.30. The Working Party leaders assess the work to be done, create a list of jobs, discuss health and safety aspects, and assign them to appropriate people.

Matters relating to the Churchyards and the Churchyard Working Party are available in the East Budleigh with Bicton Parish News and the Raleigh Mission Community website
<https://www.raleighmissioncommunity.org.uk/our-churchyards.html>
<https://www.raleighmissioncommunity.org.uk/churchyard-working-party.html>.

Table 1 provides a list of the regular Churchyard Working Party tasks:

Table 1 - Regular Churchyard Working Party Tasks
Every Month:
Brush all paths around Church and Church Hall
Sweep (and wash) the Sir Walter Raleigh steps
Spread the molehills
Empty oasis from dustbin behind Tower and take to landfill dustbin behind Shed and/or dispose
Empty flower bin and take to compost bin behind the Shed
Bag up non-recyclable rubbish (oasis, wire etc) from area behind the Shed and dustbin and take to Recycle Centre
Weed border next to Church Hall
Trim back shrubs on main path to the Church and the path to car park and clear weeds
As necessary:
Trim path edges
Apply weed killer to Church Hall patio (if conditions are right) or remove with wire brush
Cut back Valerian on main path and High Street boundary wall
Cut beech hedges, hedges around compost heap and hedges next to Church Hall
Clear particular graves in old churchyard, as required, eg, Preedy grave
Paint 'safety' lines on steps and trip hazards, as required

The earliest Parish Burial registers date from 1562. The oldest memorial in the Churchyard is dated 1795. The memorials reflect the styles and fashions of the day as well as society's views about mortality; these also reflect the change from the use of local stone to imported materials.

We have seven Grade II listed chest tombs in our Churchyard (Section K1):

- Helleman Considine Chest Tomb approximately 10m North West of the Church
- Daw Chest Tomb approximately 4m West of the Tower of the Church
- Jeffrey Chest Tomb approximately 13m North of the Aisle of the Church
- Barlow Chest Tomb approximately 12m West of the Tower of the Church
- Samuel Taylor Coldridge Chest Tomb approximately 2.5m North West of the Church
- Sheppard Chest Tomb approximately 4m West of the Tower of the Church
- Anonymous Chest Tomb approximately 2m South of the Aisle of the Church

Since 2020, we have been improving our records relating to the memorials, eg, recording the inscriptions on the memorials to confirm our existing information, finding previously missed memorials, photographing the memorials and accurately recording as much information as possible as a lot of the memorials are weathering. We had a drone take photographs of the Churchyards to help develop a new plan and drawing of the Churchyard.

As part of the National Burial Ground Survey, our Churchyards will be surveyed by AG Int'l Ltd this year. AG Int'l Ltd will give two weeks' notice so that we can get the grass cut around all the memorials - this means that we will have to have an unscheduled cut to ensure that the lower parts of the memorials can be seen when photographed.

We continue to update and improve the information about the Churchyard on display in the Church including photographs, the records of the memorials, the Management Plan, the CPRE Devon's Best Churchyard Entries and other relevant information.

Appendix D - Nature in Our Churchyards

In 1997, an Exeter University student undertook a survey and counted over 130 different tree, wild flower, fern, grass and sedge species. Since 2020, we updated the records and found that we still have most of those species and some different species. Where required and when available, we had expert help to identify and record our sedges, ferns, grasses, bryophytes and trees.

Appendix E has the list of species recorded since 2020, and shows the changes since the 1997 survey.

Between 2019 and 2021, we have sown Yellow Rattle seeds in trial areas in Section K in the hope that it will grow and weaken the coarse grass - in 2022, we had several patches of Yellow Rattle and its effect on the surrounding vegetation was very noticeable. We have sown some wild flower seeds, ie, Common Agrimony (*Agrimonia eupatoria*) and a "Premium Meadow Flower Mix" with 40+ species: wild flowers, corn field annuals and grasses - we have not seen any of these species. Interestingly in one of the Caring for God's Acre talks it was recommended not to introduce wild flower mixes but to rely on the seeds that are in the ground - we do this when spreading the molehills.

Since 2021, we have uploaded our information, including flowering species, grasses, fungi and bryophytes, to The Biological Records Centre and made it available to Caring for God's Acre, .

Following our successes in CPRE Devon's Best Churchyard Competition, we offered our Churchyards to Caring for God's Acre to include in its section of "Burial Grounds to Inspire". This was completed on 4th May 2022; see: <https://www.caringforgodsacre.org.uk/churchyard/ebudleigh-allsaints/>.

Trees and Shrubs

We shape the existing shrubs and cut back branches from gravestones where appropriate. We employ tree surgeons for the work on our large trees, eg, yews, Monterey Pine and lime tree.

A cherry tree near the Church Hall succumbed to the prolonged dry weather in 2018. Volunteers cut this down and dug out the root in 2019. A *Sorbus sargentiana* (Rowan) was selected and planted in autumn 2019.

In 2019, Advanced Arboriculture Ltd (Venmore Barn, Woodbury, Exeter) undertook a survey of the trees in the churchyard. As a result, we had work done on two trees: the Monterey Pine in the old Churchyard had dead branches removed and the dead Birch in the new Churchyard was cut down.

Following a donation in remembrance of Patrick Cuddigan, we planted a Witch Hazel in the lawn in front of the Church Hall. This donation also included a new bench (in front of the Church Hall) and paid for the new sign posts in the old Churchyard.

During the night of Saturday 30th October 2021, one of the large branches of the Yew tree outside the Porch split from the trunk and partly fell to the ground during high winds. The area was made safe on the Sunday and the branch carefully removed by Exe Arb on the Monday.

As required by the Quinquennial Inspection Report dated December 2021 / April 2022, we will undertake a survey of the trees in 2023 and take appropriate action as required.

In 2020, we measured the circumferences of our large trees at 1m above ground level:

Largest Yews:

- 3m 22cm – near Tower;
- 3m 20cm – near Church entrance;
- 3m 05cm – farthest in Section J;
- 2m 93cm - Section J near Yettington Road gate; and
- 2m 88cm - Section K

Monterey Pine: 3m 45cm

Lime: 4m 00cm

Our compost bins together with the piles of branches, eg, under the Monterey Pine, the trees, walls and hedges along some of the churchyard boundaries provide a natural habitat for various birds, insects, reptiles and mammals.

Birds

Birds seen in the field next to and in our Churchyard in 2022 included:

• Black Headed Gull	• Great Spotted Woodpecker	• Pheasant
• Blackbird	• Greenfinch	• Pied Wagtail
• Blackcap	• Green Woodpecker	• Raven ¹
• Blue Tit	• Grey Wagtail	• Redwing
• Buzzard	• Herring Gull	• Robin
• Carrion Crow	• House Martin ²	• Siskin
• Chaffinch	• House sparrow	• Song Thrush
• Chiffchaff	• Jackdaw	• Sparrow Hawk
• Coal Tit	• Jay	• Starling
• Collared Dove	• Linnet	• Stonechat
• Dunnock	• Long tailed Tit	• Swallow ²
• Fieldfare	• Love Bird ³	• Swift ²
• Goldcrest	• Magpie	• Woodpigeon
• Goldfinch	• Mistle Thrush	• Wren
• Great Tit	• Nuthatch	• Yellow Wagtail

This list was compiled by David White, East Budleigh's resident bird expert, and photographer who spends time in our Churchyards, finding them a good place for watching and photographing a variety of birds.

Notes:

1: fly over quite frequently

2: flying above churchyard hawking insects in mid/late summer

3: presumed escaped captive!

There have been fewer birds in the churchyards [and also in local gardens] - the probable cause was the most unusual weather through much of 2022's summer and autumn plus avian flu.

Following a request from Devon Birds, in April 2018 we installed a nest-box for Spotted Flycatchers in our Monterey Pine. The box was provided free and made by HMP Dartmoor for Devon Birds. We did not have any nesting flycatchers in 2018.

In the high winds in March 2019, two large branches came down and dislodged the nesting box. We put a new box in a similar position in May 2019 - this was too late to attract nesting flycatchers. We have not seen any Spotted Flycatchers from 2020 to date.

In 2020, we installed two bird boxes – one in the New Churchyard and one on the Monterey Pine. Both boxes are above 2m from ground level and face roughly east with a clear line of sight. One box has a 28mm hole – hopefully suitable for Blue Tits, Tree Sparrows and Pied Flycatchers; the other has a 32mm hole – suitable for Great Tits and larger species, eg, House Sparrows. We installed a bird box with an open entrance for Robins on a tree in the hedgerow at the back of the new Churchyard.

We have two bird feeders in the New Churchyard towards the back near the Shed as part of the 'wildlife corner'.

The plan of the "Facilities to Support Wildlife" indicates the locations of the installed bird boxes, bird feeders, insect hotels, "Bugs' B&B" and the hedgehog hotel.

Bats

There is a significant bat population in East Budleigh and bats regularly fly around the Church Tower. Thursday 16th July 2020, Kate Ponting and Sarah Butcher, a bat expert, detected and recorded five of the 16 bat species in Devon: Common Pipistrelle, Soprano Pipistrelle, Serotine, Noctule and a Myotis. We had several sightings of the Pipistrelles in the Churchyard. There was also a far-off Barbastelle detected.

Reptiles

Whilst delineating one of the graves, we were very pleased to find three slow worms; in another there was a toad. There have been many sightings of slow worms in the old Churchyard. We have asked people to be careful when working as we now know that reptiles inhabit the churchyards.

Insects and Arachnids

Woodlice, spiders live in the shed! Many insect species visit the Churchyards, eg, bumblebees, wasps, bees, hover flies, false wasps, bee flies, ladybirds, flies, butterflies, moths and beetles.

Insects photographed since 2020 include:

- Butterflies: Brown Argus; Comma; Marble White; Common Blue; Painted Lady; Red Admiral; Wall Brown; Orange Tip; Speckled Wood; Small Copper; Red Admiral; Meadow Brown
- Moths: Jersey Tiger Moth, Micro Moth
- Beetles: *Meloe violaceus*, the Violet Oil Beetle - many seen in Spring; *Oedemera nobilis*, also known as the false oil beetle, thick-legged flower beetle or swollen-thighed beetle; thick-kneed pollen beetle; *Dolycoris baccarum*, the hairy or sloe shieldbug; Common Dung Beetle; Seven-Spot Ladybird
- *Orchelimum*, Meadow grasshopper; Common Field grasshopper
- Common Blue damselfly; banded demoiselle

As part of the 2020 Management Plan, we installed a "Bugs' B&B", using recycled pallets, old branches and timber, cardboard, straw and stones, at the back of the new Churchyard close to the hedge and near the hedgehog hotel.

We have a small 'insect hotel' in the new churchyard. We have moved the 'insect hotel', donated by Bicton College, from above the Garden of Remembrance to a new location above the New Churchyard.

Moles

We have moles living in our churchyards, which cause a lot of disruption particularly in the Garden of Remembrance. Every month, our volunteers carefully rake out the molehills and resurrect the flower vases on the memorials in the Garden of Remembrance. They also rake out molehills in the old Churchyard and around the Church, to help with mowing. Raking the molehills rather than removing the soil ensures that any seeds are kept within the Churchyards.

Other Mammals

Squirrels and rabbits are often seen in the Churchyards.

We have seen shrews/voles scurrying through the cracks in our shed!

Worms

Worms thrive in the compost heap and in the Churchyards. According to The Earthworm Society of Britain there are 29 earthworm species and we hope to investigate which ones exist in our Churchyard in the future.

Lichens

The memorials and kerbstones are left in place to provide a natural habitat and protection for lichens. During the Safety Test, some memorials were laid down – these have been left in place. We have cleared ivy off some memorials where the ivy was affecting the inscriptions and/or was growing too much and engulfing the memorial. We do not remove lichens from the memorials and kerbstones.

Our Churchyards support many lichens on the memorials, trees and grassland. There are many varieties of lichen on the memorials due to:

- the different rock types, eg, sandstone, limestone, marble, granite and mortar
 - the stonework surfaces varying from rough to smooth
 - memorials being in the shade and areas exposed to the sun with some dry and some damp
 - memorials being vertical or horizontal
- all of which provide different niches for the lichens.

Nicola Bacciu, British Lichens Society, visited on Monday 11th April 2022 and recorded 55 different lichens.

Fungi

Our regular grass mowing around the Church supports fungi, eg, Scarlet, Slimy, Snowy, Parrot and Blackening Waxcaps, Witches Hat, and Brown Mottlegill. Sulphur tuft fungi have been seen in the Church Hall border (January 2022). In 2022, we also had Dog's Vomit Slime Mould in Section E near the main path to the Church; False Chanterelle Section J; Boletus/Hortiboletus. Amanita, Elastic Saddle, White Spindle and Meadow Coral in Section H.

Walls

The wall along the High Street up to the steps opposite the Sir Walter Raleigh statue has Valerian growing out of it and creates a riot of colour when flowering – this is cut back after flowering.

The wall between the Old Churchyard and New Churchyard contains many species including: ivy and ivyleaved toadflax, dandelions, thistles, ferns in variety, bindweed, and stonecrop.

The many species thrive between the edges of tarmac / grassy footpaths and kerbstones / walls, eg, violet, speedwell, thale cress, thistle and red dead nettle.

The Church wall from the steps opposite the Sir Walter Raleigh statue and up Yettington Road is a haven for ivy, ferns, maidenhair spleenwort, mosses, valerian, daisies and ivyleaved toadflax and grasses, dandelions, hairy bittercress and other species in the join with the road gutter, eg, thistles.

Penny and Paul Kurowski
Churchyard Working Party Leaders
e-mail: churchyard.as@rmcommunity.co.uk

Facilities to Support to Wildlife



Appendix E - Species Recorded since 2020

Flowering Species	Common Name		Date	Area	Not in 1997 list
<i>Achillea millefolium</i>		Yarrow	19-Jun-20	Church hall area and K3	
<i>Ajuga reptans</i>		Bugle	25-Apr-20	H	Yes
<i>Allium triquetrum</i>	Three-cornered	Leek	16-May-20	New churchyard by hedge. Invasive, so pulled it out.	Yes
<i>Allium vineale</i>	Crow	Garlic	05-Jun-20	New churchyard by wall, K	
<i>Anagallis arvensis</i>	Scarlet	Pimpernel	01-Jun-21	Church Hall patio	
<i>Anthriscus sylvestris</i>		Cow Parsley	24-Apr-20	J	
<i>Arabidopsis thalia</i>	Thale	Cress	15-Mar-20	Path edge near porch	Yes
<i>Arum maculatum</i>		Lords and Ladies	20-Mar-20	Throughout	
<i>Ballota nigra</i>	Black	Horehound	05-Jun-20	by concrete drive, and near shed	
<i>Bellis perennis</i>		Daisy	20-Mar-20	in short grass throughout	
<i>Calystegia silvatica</i>	Great	Bindweed	05-Jun-20	Hedge at back of J	
<i>Cardamine hirsuta</i>	Hairy	Bittercress	20-Mar-20	In bare ground eg CH border	
<i>Cardamine pratensis</i>	Cuckoo	Flower	24-Apr-20	K2	Yes
<i>Carex divulsa</i>	Grey	Sedge	29-Jun-21	Near top of SWR steps	
<i>Centranthus ruber</i>	Red	Valerian (red, white, pink)	18-Apr-20	Wall and sides of path leading from High Street	
<i>Cerastium fontanum</i>	Common	Mouse-ear	10-May-20	K1	Yes
<i>Cerastium glomeratum</i>	Sticky	Mouse-ear	10-May-20	J	
<i>Cirsium arvense</i>	Creeping	Thistle	17-Jul-20	Various	
<i>Cirsium vulgare</i>	Spear	Thistle	23-Jun-20	Various	
<i>Conium maculatum</i>		Hemlock	24-Jun-20	by concrete drive	
<i>Convolvulus arvensis</i>	Field	Bindweed	19-Jun-20	K3	
<i>Crepis capillaris</i>	Smooth	Hawksbeard	25-Apr-20	K1 - don't think this is Beaked Hawksbeard as not downy	Yes
<i>Crepis vesicaria</i>	Beaked	Hawksbeard	17-May-20	K (could possibly be <i>Crepis biennis</i> but outer florets are orange beneath, not yellow)	
<i>Crocus nudiflorus</i>	Autumn	Crocus	17-Oct-21	Near Yettington Road gate	
<i>Cymbalaria muralis</i>	Ivyleaved	Toadflax	20-Mar-20	On various walls	
<i>Dipsacus fullonum</i>		Teasel	23-Jun-20	Behind shed	

Flowering Species	Common Name		Date	Area	Not in 1997 list
<i>Epilobium hirsutum</i>	Great	Willowherb	29-Jun-20	K2	
<i>Epilobium tetragonum</i>	Square-stemmed	Willowherb	05-Jun-20	By wall in new churchyard	Yes
<i>Erigeron karvinskianus</i>	Mexican	Fleabane	18-Apr-20	Wall with High Street	
<i>Euphorbia peplus</i>	Petty	Spurge	05-Jun-20	Church Hall patio	
<i>Fragaria vesca</i>	Wild	Strawberry	25-Apr-20	K2	
<i>Fumaria officinalis</i>		Fumitory	28-Mar-20	Behind shed	
<i>Galanthus nivalis</i>		Snowdrop	16-Jan-20	Mainly H and J & K near church	
<i>Galium aparine</i>		Cleavers	07-May-20	New churchyard	
<i>Galium verum</i>	Lady's	Bedstraw	17-Jul-20	K3	Yes
<i>Geranium dissectum</i>	Cut-leaved	Cranesbill	07-May-20	K3	
<i>Geranium pyrenaicum</i>	Hedgerow	Cranesbill	17-May-20	J	Yes
<i>Geranium robertianum</i>		Herb Robert	09-May-20	Throughout	
<i>Glechoma hederacea</i>		Ground Ivy	05-Jun-20	K	
<i>Hedera</i>		Ivy	23-Sep-20		
<i>Heracleum sphondylium</i>		Hogweed	17-May-20		
<i>Hycinthoides non-scripta x hispanica</i>	Spanish	Bluebell	10-Apr-20	In CH border, with ?hybrids with natives in H and J	
<i>Hypochaeris radicata</i>	Common	Catsear	10-May-20	K1	
<i>Iris foetidissima</i>	Stinking	Iris	28-May-20		
<i>Lamium album</i>	White	Deadnettle	27-Mar-20	Beside concrete drive to hall	Yes
<i>Lamium purpureum</i>	Red	Deadnettle	26-Mar-20	New churchyard	Yes
<i>Lapsana communis</i>		Nipplewort	05-Jun-20	K1	
<i>Lathyrus pratensis</i>	Meadow	Vetchling	02-Aug-20	Bed in CH Patio	
<i>Leontoides taraxacoides</i>	Lesser	Hawkbit	05-Jun-20	Church hall patio. Certainly a hawkbit, probably this one. Underside of petals greyish.	Yes
<i>Leucanthemum vulgare</i>	Oxeye	Daisy	07-May-20	H, spreading into J and K	
<i>Lotus corniculatus</i>	Birdsfoot	Trefoil	17-May-20	J	
<i>Malva neglecta</i>	Dwarf	Mallow	17-Jun-20	by concrete drive	Yes

Flowering Species	Common Name		Date	Area	Not in 1997 list
Medicago arabica	Spotted	Medick	25-Apr-20	J	Yes
Medicago lupulina	Black	Medick	10-May-20	J	
Myosotis arvensis	Field	Forget-me-not	14-May-21	Near Church Tower	
Narcissus pseudonarcissus	Wild	Daffodil	19-Feb-20	H, spreading into J alongside road	
Oxalis articulata	Pink	Oxalis	25-Apr-20	J	Yes
Oxalis europaea	Upright yellow	Oxalis	14-Apr-21	Against Church wall (south side)	Yes
Papaver rhoeas		Poppy	17-Jun-20	Path edge near porch (also 23 Sept in K1)	
Papaver somniferum	Opium	Poppy	05-Jun-20	Church Hall border	
Parietaria Judaica		Pellitory of the wall	28-May-20	Church Hall patio	
Pentaglottis sempervirens	Green	Alkanet	20-Mar-20	New churchyard near shed	
Plantago lanceolata	Ribwort	Plantain	07-May-20	K	
Plantago major	Greater	Plantain	08-Jul-20	Church Hall patio	
Polygonum aviculare		Knotgrass	05-Jun-20	Church Hall patio	
Potentilla reptans	Creeping	Cinquefoil	29-Jun-20	maybe on 29th June - 5 petals, not rooting, 3-5 leaflets	
Potentilla sterilis	Barren	Strawberry	09-Mar-20	Church Hall border	
Primula vulgaris		Primrose	19-Feb-20	Mainly H and J & K near church	
Prunella vulgaris		Self Heal	05-Jun-20	Church Hall patio	
Ranunculus acris	Meadow	Buttercup	23-Sep-20	K1	
Ranunculus bulbosus	Bulbous	Buttercup	24-Apr-20	Throughout (sepals definitely turned downwards)	Yes
Ranunculus ficaria	Lesser	Celandine	20-Mar-20	Throughout	
Ranunculus repens	Creeping	Buttercup	24-Apr-20	Throughout (need to check this identification next year)	
Raphanus sp		Raddish	12-Aug-22	D. Not sure if this is Raphanus raphanistrum (wild radish) or sativus (garden radish)	
Rosa canina	Dog	Rose	05-Jun-20	Behind church hall	Yes
Rosa pimpinellifolia	Burnet	Rose		?flowering early June on sides of path leading up from High St	
Rubus fruticosus		Bramble	23-Jun-20	Hedges	
Rumex acetosa	Common	Sorrel	25-Apr-20	K1	

Flowering Species	Common Name		Date	Area	Not in 1997 list
Sagina		Pearlwort	28-May-20	Church Hall border	
Sedum acre	Biting	Stonecrop	09-Jun-20	Wall near shed	
Senecio jacobaea		Ragwort	29-Jun-20	K2	
Senecio vulgaris		Groundsel	28-May-20		
Silene dioica	Red	Campion	24-Apr-20	next to drive	
Solanum nigrum	Black	Nightshade	03-Jul-22	Path edge on Church path between A and B. Seen again July 2022 - between A and B.	
Soleirolia soleirolii		Mind your own business	28-May-20	around church	
Sonchus aasper	Prickly	Sowthistle	17-May-20	Near hedge in new Churchyard, (also near High St gate)	
Sonchus arvensis	Perennial	Sowthistle	24-Apr-20	J. need to check this as it seems a bit early to flower in April	Yes
Sonchus oleraceum	Smooth	Sowthistle	10-May-20	K2	
Sorbus aucuparia		Rowan	24-Apr-20	E	
Stellaria holostea	Greater	Stitchwort	26-Mar-20	J	Yes
Stellaria media		Chickweed	08-Jul-20	K	
Taraxacum		Dandelion	19-Mar-20	Throughout	
Tragopogon pratensis		Goatsbeard	05-Jun-20	J (also known as Jack go to bed at Noon)	
Trifolium campestre	Hop	Trefoil	09-Jul-20	CH lawn	
Trifolium dubium	Lesser	Trefoil	06-Jun-22	In grass around / near Sir Walter Raleigh steps	
Trifolium pratense	Red	Clover	25-Apr-20	H	
Trifolium repens	White	Clover	05-Jun-20	widespread in mown areas	
Urtica dioica		Nettle	05-Jun-20	throughout	
Valerianella locasta		Cornsalad	18-Apr-20	CH border and front of church	
Verbascum thapsus		Verbascum	17-Jul-20	by concrete drive	Yes
Veronica chamaedrys	Germander	Speedwell	26-Mar-20	J	
Veronica filiformis	Slender	Speedwell	05-Jun-20	K1 next to Trump path	
Veronica hederifolia	Blue ivy leaved	Speedwell	26-Mar-20	?lilac variety behind shed	
Veronica persica	Field	Speedwell	26-Mar-20	throughout	
Veronica serpyllifolia	Thyme leaved	Speedwell	14-May-21	In lawn near Chuch Hall patio	

Flowering Species	Common Name		Date	Area	Not in 1997 list
Vicia hirsuta	Hairy	Tare	10-May-20	J	Yes
Vicia sativa	Common	Vetch	24-Apr-20	H	
Viola odorata	Sweet	Violet	? -20	None of the violets had scent in 2020, 2021 or 2022	
Viola riviana	Dog	Violet	22-Feb-20	H	Yes

Sedge Species	Common Name		Date seen	Area	Not in 1997 list
Luzula campestris	Field	Woodrush or Good Friday Grass	30-Mar-20	throughout in short grass	
Carex divulsa	Grey	Sedge	29-Jun-21	Near top of SWR steps	

Fern Species: Latin Name	Common Name		Date seen	Area	Not in 1997 list
Asplenium adiantum-nigrum	Black	Spleenwort	05-Jun-20	on walls	
Asplenium trichomanes	Maidenhair	Spleenwort	30-Mar-20	on walls	
Dryopteris felix-mas	Male	Fern	05-Jun-20	K1	Yes
Polypodium vulgare	Common	Polypody	05-Jun-20	on walls	

Grass Species - Latin Name	Common Name		Date seen in 2020	Area	Comment	Not in 1997 list
Alopecurus pratensis	Meadow	Foxtail	25-Apr-20	K2	Sheena checking	Yes
Anthoxanthum odoratum	Sweet	Vernal	25-Apr-20	K1		
Arrhenatherum elatium	False	Oatgrass	05-Jun-20	widespread		
Bromopsis ramosa	Hairy	Brome	11-May-20	fairly widespread	Identification difficult but leaves are definitely hairy, as confirmed by Sheena P 5 June	Yes
Bromus sterilis	Barren	Brome	05-Jun-20	?near High St gate	? Could be hairy brome	
Dactylis glomerat		Cocksfoot	11-May-20			

Festuca	Red/sheeps	Fescue	05-Jun-20	H	near Yettington Road path	Yes
Festuca pratensis	Meadow	Fescue	17-May-20	K	(think renamed Schedonorus pratensis)	
Holcum lanatus		Yorkshire Fog	05-Jun-20	widespread		
Lolium perenne	Perennial	Ryegrass	11-May-20	H		
Poa annua	Annual	Meadowgrass	05-Jun-20	widespread		
Schedonorus gigantea	Giant	Fescue	17-May-20	J and K		Yes

Bryophyte Species	Common Name	Date	Area	Identified by:
Amblystegium serpens		28/10/20	On soil	Brad Scott
Atrichum undulatum		28-Oct-20	Among grass	Brad Scott
Barbula unguiculata		28-Oct-20	On soil	Brad Scott
Brachythecium rutabulum		01-Jan-21	K1 Base of cross with Homalothecium sericum growing on it	Sheena Patterson
Brachythecium rutabulum		28-Oct-20	On soil	Brad Scott
Bryum capillare	Capillary thread moss	01-Jan-21	low roof on north side of church	Sheena Patterson
Bryum capillare		28-Oct-20	On masonry	Brad Scott
Calliergonella cuspidata		28-Oct-20	Among grass	Brad Scott
Calliergonella cuspidata	Pointed Spear Moss	01-Jan-21	Grass on north side of church	Sheena Patterson
Dicranella schreberiana		28-Oct-20	On soil	Brad Scott
Didymodon insulanus		28-Oct-20	On soil	Brad Scott
Fissidens taxifolius		28-Oct-20	On soil	Brad Scott
Frullania - either dilatata or tamarisci	(Dilated or Tamarisk Scalewort)	01-Oct-20	base of cross in area behind compost heaps	Sheena Patterson
Grimmia pulvinata		01-Jan-21	Chest tomb on south side of church	Sheena Patterson
Grimmia pulvinata		28-Oct-20	On tombstone	Brad Scott
Homalothecium sericeum		28-Oct-20	On tombstone	Brad Scott
Homalothecium sericum	Silky Wall Feather Moss	01-Oct-21	low roof on north side of church, cross in K1	Sheena Patterson
Kindbergia praelonga		28-Oct-20	Among grass	Brad Scott
Pohlia melanodon		28-Oct-20	On soil	Brad Scott

Bryophyte Species	Common Name	Date	Area	Identified by:
Pseudoscleropodium purum		28-Oct-20	On soil	Brad Scott
Rhizomnium punctatum		28-Oct-20	On soil	Brad Scott
Rhynchostegiella tenella		25-Oct-20	on wall in churchyard	Brad Scott
Rhynchostegium confertum		28-Oct-20	On masonry	Brad Scott
Rhytidiadelphus squarrosus		01-Jan-21	Grass near gate to car park	Sheena Patterson
Rhytidiadelphus squarrosus		28-Oct-20	Among grass	Brad Scott
Syntrichia montana		01-Jan-21		Sheena Patterson
Syntrichia montana		28-Oct-20	On tarmac	Brad Scott
Tortula muralis		28-Oct-20	On tombstone	Brad Scott
Orthotrichum anamalum		21-Feb-21	On light plinth near chest tombs	Sheena Patterson
Leucodon sciuroides	Squirrel-tailed moss	01-Jan-21	On ground ?fallen from Church Tower	
Hypnum cupressiforme	Cypress-leaved Plait-moss	07-Sep-20	On soily part of path, verified by Mark Pool	
Syntrichia latifolia	Water screw-moss	18-May-21	Path alongside Church	
Lophocolea bidentata	Bifid crestwort	25-Feb-22	Path edge by low roof	

Fungi Species	Common Name		Date	Area	
Hygrocybe psittacina	Parrot	waxcap	03-Nov-21	H	
Hygrocybe irrigatus	Slimy	waxcap	03-Nov-21	H	
Hygrocybe nivea	Snowy	waxcap	07-Nov-21	K1/2	
Inocybe			03-Nov-21	J 3	
Mucilago crustacea	Dog vomit	slime mould	18-Nov-21	E	
Hygrocybe nigrescens	Blackening/Witches Hat	waxcap	07-Nov-21	H	
Hygrocybe pratensis	Meadow	waxcap	19-Nov-21	H	
Clavaria vermicularis	White	spindles	19-Nov-21	H	
Coprinus comatus	Shaggy	ink cap	19-Nov-21	New Churchyard	
Hypholoma fasciculare	Sulphur	Tufts	20-Jan-22	Church Hall border	

Fungi Species	Common Name		Date	Area	
Laetiporus sulphureus	Sulphur polypore or	Chicken of the Woods	30-Aug-22	On yew near porch	
Helvella elastica	Elastic	Saddle	17-Nov-22	H near Yettington Rd Path	
Clavulinopsis corniculata	Meadow	Coral	17-Nov-22	H near Yettington Rd Path	
Lepiota		Parasol	17-Nov-22		
Boletus		Boletus	25-Oct-22		

Lichens recorded in the Churchyard and Church Walls on 11 April 2022

Species	BLS no.	Taxon name
Arthonia pruinata	0063	Pachnolepia pruinata
Opegrapha prosodea	0956	Opegrapha prosodea
Acarospora fuscata	0010	Acarospora fuscata
Physcia caesia	1114	Physcia caesia
Lecanora polytropa	0667	Lecanora polytropa
Buellia aethalea	0200	Buellia aethalea
Lecidea fuscoatra	0724	Lecidea fuscoatra s. lat.
Candelariella vitellina	0298	Candelariella vitellina f. vitellina
Pyrrhospora querneae	1228	Pyrrhospora querneae
Diploicia canescens	0491	Diploicia canescens
Tephromela atra	0630	Tephromela atra var. atra
Haematomma ochroleucum	1547	Haematomma ochroleucum s. lat.
Lecanora campestris	0635	Lecanora campestris subsp. campestris
Ochrolechia parella	0926	Ochrolechia parella
Lecidea stigmatea	0803	Lecidella stigmatea
Lecanora orosthea	0757	Lecanora orosthea
Buellia ocellata	0219	Buellia ocellata
Melanelixia fuliginosa	0998	Melanelixia fuliginosa
Rhizocarpon geographicum	1257	Rhizocarpon geographicum
Lecidea fuscoatra	0724	Lecidea fuscoatra s. lat.
Porpidia tuberculosa	0572	Porpidia tuberculosa
Verrucaria fusconigrescens	1491	Verrucaria fusconigrescens
Ochrolechia parella	0926	Ochrolechia parella
Xanthoparmelia mougeotii	1005	Xanthoparmelia mougeotii
Solenopsora candicans	1324	Solenopsora candicans
Caloplaca flavescens	0259	Caloplaca flavescens
Verrucaria nigrescens	1510	Verrucaria nigrescens f. nigrescens
Verrucaria baldensis	1479	Verrucaria baldensis
Protoblastenia rupestris	1189	Protoblastenia rupestris
Verrucaria viridula	1518	Verrucaria viridula
Catillaria lenticularis	0311	Catillaria lenticularis
Lecanora albescens	0627	Lecanora albescens
Collema auriforme	0433	Collema auriforme
Aspicilia calcarea	0103	Aspicilia calcarea
Caloplaca dalmatica	0285	Caloplaca dalmatica
Verrucaria hochstetteri	1495	Verrucaria hochstetteri
Caloplaca dichroa	2443	Caloplaca dichroa
Diploicia canescens	0491	Diploicia canescens
Caloplaca aurantia	0239	Caloplaca aurantia

Species	BLS no.	Taxon name
Aspicilia calcarea	0103	Aspicilia calcarea
Placopyrenium fuscillum	1492	Placopyrenium fuscillum
Aspicilia contorta	0107	Aspicilia contorta subsp. contorta
Toninia aromatica	1415	Toninia aromatica
Verrucaria calciseda	1480	Verrucaria calciseda
Collema fuscovirens	0463	Collema fuscovirens
Collema crispum	0440	Collema crispum var. crispum
Diploicia canescens	0491	Diploicia canescens
Solenopsora candicans	1324	Solenopsora candicans
Caloplaca flavescens	0259	Caloplaca flavescens
Lecanora albescens	0627	Lecanora albescens
Caloplaca dalmatica	0285	Caloplaca dalmatica
Dirina massiliensis	0500	Dirina massiliensis f. sorediata
Lecanora crenulata	0644	Lecanora crenulata
Diplotomma alboatrum	0496	Diplotomma alboatrum
Lecanographa grumulosa	0597	Paralecanographa grumulosa

Note: BLS = British Lichen Society

Species seen in 1997 but not in 2020 - 2022

Flowering Species	Common Name	
Alliaria petiolata	Garlic	Mustard
Antirrhinum majus		Snapdragon
Arctium minus	Lesser	Burdock
Arenaria serpyllifolia	Thyme leaved	Sandwort
Artemisia vulgaris		Mugwort
Capsella bursa-pastoria		Shepherd's Purse
Coronopus didymus	Lesser	Swinecress
Geranium molle	Dovesfoot	Cranesbill
Lonicera		Honeysuckle
Matricaria discoidea		Pineapple weed
Polygonum persicaria		Redshank
Prunus avium	Wild	Cherry Note 1
Rumex obtusifolius	Broad leaved	Dock
Sambucus nigra		Elder
Sedum reflexum	Reflexed	Stonecrop
Sinapis arvensis		Charlock
Sisymbrium officinale	Hedge	Mustard
Stachys sylvatica	Hedge	Woundwort
Stellaria graminea	Lesser	Stitchwort
Tanacetum vulgare		Tansy

Flowering Species	Common Name	
Veronica arvensis	Wall	Speedwell
Vicia sepium	Bush	Vetch

Note 1 - this appears in the list of Trees

Sedge Species	Common Name	
Carex spicata	Spiked	Sedge

Fern Species	Common Name	
Asplenium ruta-muraria		Wall-rue
Phyllitis scolopendrium		Hartstongue

Grass Species	Common Name	
Agrostiscapillaris	Common	Bentgrass
Cynosurus cristatus	Crested	Dogstail
Deamazeria rigida	Fern	Grass
Poa compressa	Flattened	Meadowgrass
Poa trivialis	Rough	Meadowgrass

Trees - listed in 2002 by East Budleigh in Bloom (EBiB)

Species	Common Name		EBiB No.	Area	Notes
Taxus baccata		Yew	CY1	F	
			CY3	G	
			CY4	H	
			CY14	J	
			CY17	K	
			CY20	K	
			CY24	K	
Taxus fastigata	Irish	Yew	CY5	H	
			CY9	H	
			CY11	H	
			CY13	J	
			CY21	K	
			CY22	K	
			CY23	K	
			CY25	K	
			CY26	K	
			CY27	K	
Pinus radiata	Monterey	Pine	CY18	J	
Sorbus aucuparia	Mountain	Ash	CY2	G	
			CY10	H	
			CY46	C Hall	Planted Autumn 2019
Betula pendula	Silver	Birch	CY28	K	
			CY41	New CY	Died & blown over 19-Feb-22
Fagus sylvatica		Beech	CY35	New CY	
			CY36	New CY	
			CY37	New CY	
			CY38	New CY	
			CY39	New CY	
Ulmus procera	English	Elm	CY40	New CY	Died & cut down in 2020
Acer pseudoplatanus		Sycamore	CY29	K	
			CY43	GoR	

Species	Common Name		EBiB No.	Area	Notes
Acer campestre	Field	Maple	CY7	H	
Thujaopsis dolabrata		Hiba	CY8	H	
Chamaecyparuss		Cypress	CY19	K	
			CY31	New CY	
Acer platanoides	Norway	Maple	CY32	New CY	
			CY33	New CY	
Ilex aquifolium		Holly		F	
				K	
				C Hall	
Tilia x coropaea	Common	Lime	CY12	H	
Fraxinus excelsior		Ash	CY6	H	
Prunus			CY15	J	
Prunus	Flowering	Cherry	CY30	New CY	
			CY34	New CY	
			CY42	C Hall	
			CY44	C Hall	
			CY45	C Hall	Died
Malus hybrid	Purple	Crab Apple	CY16	J	
New since 2020					
Sorbus aucuparia		Rowan		E	previously listed in flowers!
Planted 25 th April 2020					

Plan - Trees

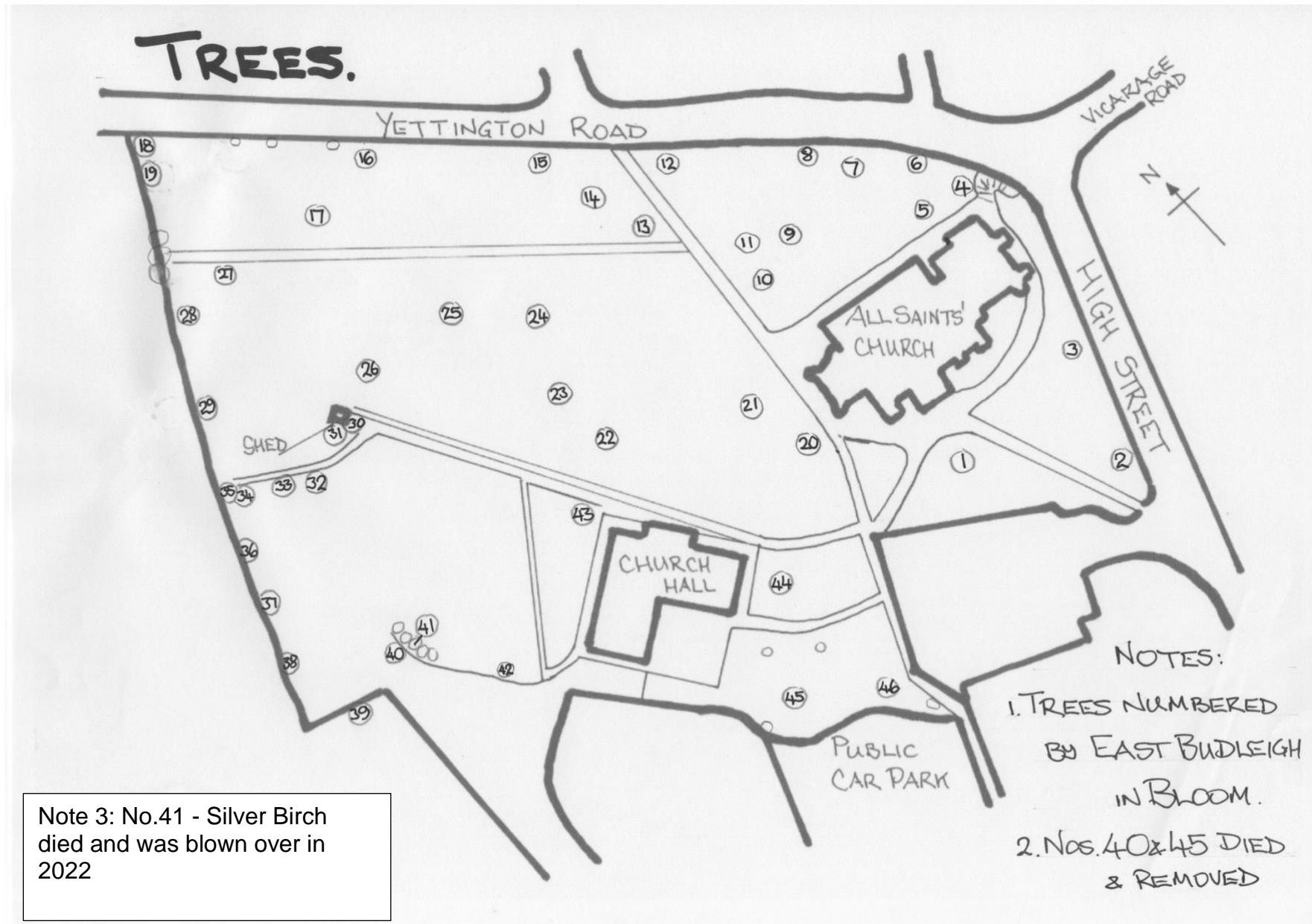

Appendix F - Management Plan for Grass Cutting

Background Information

Regime up to June 2018

Between April and December each year, we used Community Payback, Exeter, to keep the grass cut around the Church and Church Hall at a cost of £120 per visit.

Towards the end of the year after the grasses and flowers had seeded, Community Payback strimmed the long grass and vegetation in the old Churchyard; however, the 'workers' were not very good at clearing the cuttings and sometimes the work was delayed or cancelled completely because of the weather and staff availability. Over the years, this resulted in a dramatic change in the biodiversity, eg, very tall coarse grasses and hogweed tended to predominate.

We wanted to improve the biodiversity in the old Churchyard, reduce the hogweed, and improve accessibility to the memorials. To develop our thinking, we had discussions with a number of experts early in 2018. As a result, we decided to aim to keep Section H as a wonderful 'spring meadow' with its early snowdrops, bluebells, primroses, crocuses and ox-eye daisies and develop Sections J and K into 'summer meadows' and restore a variety of wild flowers.

In the late summer/ autumn of 2018, we employed Andy Heath, a local gardener, to strim and thoroughly clear the old Churchyard, ie, Sections J and K. The vegetation was allowed to grow back over the winter months. We employed Andy because he understands what we are trying to achieve, and he takes great care to remove the arisings so as not to further enrich the soil and encourage the coarse grasses.

The transformation was amazing as in early 2019, we had flowers that we had not seen in Sections J and K during the last three years, eg, bluebells, primroses, crocuses and stitchwort. Other wild flowers became visible as we progressed through the year.

2019 Grass Cutting Regime

The cutting plan for 2019 was:

Area to be cut	No. Cuts in the Year	Period
Church Hall, Sections A, B, C, D, E, F, and G	8	Monthly: March to October inclusive
Section H	3	Jan/Feb, mid-June after flowers, and Sept/Oct
Section J	5	early Apr, mid-May, early Jul, late Aug, and Sept/Oct
Section K	5	early Apr, mid-May, early Jul, late Aug, and Sept/Oct

It was not necessary to cut Sections "J" and "K" in August.

Our new regime meant that we produced more cuttings and started another pile at the back of the new Churchyard. None of the local farmers wanted the grass so we reduced the heap by taking some of it to the 'green waste' at the Exmouth and the Sidmouth Recycling Centres when having trips in those directions.

2020 Grass Cutting Regime

We adjusted the grass cutting plan to accommodate the planned BioBlitz on Tuesday 2nd June - due to the pandemic this did not happen.

Rather than cutting Section “K” as one whole block, we split it into three sub-sections with different timings for the cuts to develop a succession in growths.

Sub-section 1 is from the Church to the large yew where there is a grass track.

Sub-section 2 is from the large yew/grass track to the grass track starting close to the shed and European yew – we are trying to delineate the memorials/graves by the end of March.

Sub-section 3 is from the shed/European yew grass track to the hedge at the back of the Churchyard – this was the most overgrown part of the Churchyard.

In 2020, we adjusted the cutting plan with respect to the weather, the flowers and the seasons.

Area to be cut	No. Cuts in the Year	Period
Church Hall, Sections A, B, C, D, E, F, and G	8	Monthly: March to October inclusive
Section H (spring meadow)	3	Feb (avoiding flowers), mid-June after flowers, and late Sept/Oct
Section J (developing summer meadow)	3-4	early Apr, mid-June/early July, late Aug (if required), and late Sept/Oct
Section K (developing summer meadow)		
Sub-section 1	4	April, mid-June/early July, late Aug, and Sept/Oct
Sub-section 2	3	March, July, and Sept/Oct
Sub-section 3	4-5	Feb, early Apr, mid-May, late Aug (if required), and Sept/Oct

Despite the Coronavirus pandemic, whilst complying with Government, Diocese of Exeter and Church of England guidelines, Andy was able to cut the grass generally in accordance with the plan.

2021 Grass Cutting Regime

Based on the continuing development the spring meadow in Section H and the summer meadows in Sections J and K, the grass cutting regime is outlined below:

Area to be cut	No. Cuts in the Year	Period
Church Hall, Sections A, B, C, D, E, F, and G	8	Monthly: March to October inclusive
Section H (spring meadow)	3	Feb (avoiding bulbs), mid-July/August after flowers, and Sept/Oct
Section J (summer meadow)	3-4	March/Apr, July/August, and late Sept/Oct
Section K (summer meadow)		
Sub-section 1	3	March/April, June and Sept/Oct
Sub-section 2	3	February/March and Sept/Oct
Sub-section 3	4	February/March, July, and Sept/Oct

We decided to not cut Sub-section K2 in July to deliberately let nature ‘flourish’.

Lesson: Sub-section K2 did not increase in the diversity of flowering plants and was harder to cut in September resulting in four days to complete the work!

Andy started the grass cutting in March 2021. We adjusted the cutting plan with respect to the weather, the flowers and the seasons.

